

## QPD4-4000-12000-20-S

### 4-Way, 4~12GHz

**Features:**

- \* Small Size
- \* Low Insertion Loss

**Applications:**

- \* Amplifiers
- \* Mixers
- \* Antennas
- \* Laboratory Test

**Electrical**

Frequency:	4~12GHz
Insertion Loss:	1.2dB max.
Input VSWR:	1.4 max.
Output VSWR:	1.3 max.
Isolation:	18dB min.
Amplitude Balance:	±0.2dB
Phase Balance:	±4°
Impedance:	50Ω
Average Power:	20W max. 1W max. as combiner

**Mechanical**

Size*1:	60*54*10mm 2.362*2.126*0.394in
Weight:	88g
Connectors:	SMA Female
Mounting:	4-Φ2.8mm through-hole

[1] Exclude connectors.

**Environmental**

Operation Temperature:	-45~+85°C
------------------------	-----------

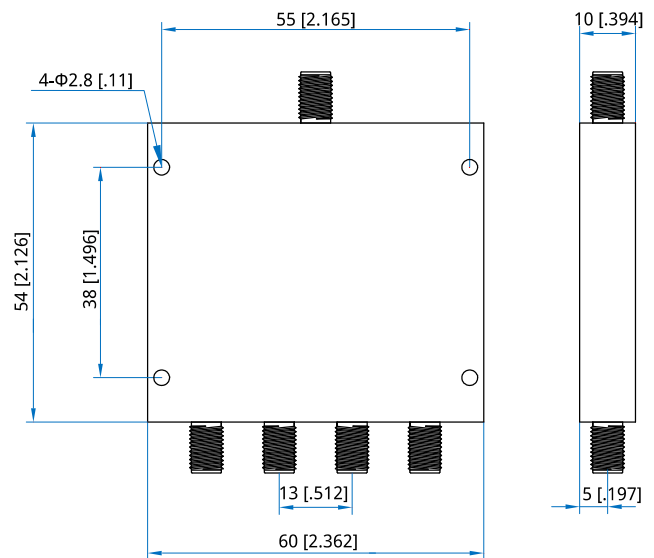
**Outline Drawings**

Unit: mm [in]

Tolerance: ±0.5mm [±0.02in]

**How To Order**

**QPD4-4000-12000-20-S**

Customization is available upon request.